



Wood



CREATE BEYOND CONVENTION

HETEROFOCUS 1400

Installation and User Manual

Tested by OMNI-Test Laboratories, Inc. and approved in accordance with:

UL 737-2011 and ULC S627-23

US EPA EXEMPT

Report number : 0304WF020S

This document was provided with your Focus fireplace.

PLEASE READ AND RETAIN THIS MANUAL



CONTENTS

INTRODUCTION	04
SPECIFICATIONS	05
■ DETAILED PLAN	05
■ ROOF OUTLET REQUIREMENTS	06
■ CHIMNEY REQUIREMENTS	06
■ SUPPORTING STRUCTURE RULES	06
■ CONNECTORS	07
■ FRESH AIR INLET DEVICE	07
■ FLOOR AND CEILING CLEARANCE REQUIREMENTS	08
■ WALL CLEARANCE REQUIREMENTS	09
■ MATERIALS, PARTS, AND TOOLS INCLUDED FOR INSTALLATION	10
INSTALLATION	11
■ FIREPLACE INSTALLATION	11
USE	13
■ HANDLING FLAMMABLE PRODUCTS	13
■ HEARTH BASE	13
■ ASHES	13
■ FUEL	13
■ SPARK GUARD	14
■ BEFORE YOUR FIRST FIRE	15
■ LIGHTING AND MAINTAINING YOUR FIRE	15
■ PROTECTIVE GLOVES	15
■ OPERATING AND USING THE DAMPER	16
MAINTENANCE	17
■ ASH REMOVAL	17
■ CREOSOTE FORMATION	17
■ CHIMNEY SWEEPING	17
■ SURFACE CLEANING	18
■ SPARE PARTS	18
WARRANTY	18

INTRODUCTION

Please read this entire manual before proceeding with installation and use. Failure to follow the instructions in this manual may result in serious property damage and bodily injury, including fatal injury. Be sure to contact local authorities for additional information on regulations in your area. Failure to comply with this manual will automatically void the Focus warranty.

Consult with competent authorities (e.g., municipal building services, fire departments, fire prevention offices) before installation to determine if a permit is required.

All **WARNINGS** and **SAFETY RULES** will appear in highlighted boxes.

Keep this manual in an accessible location for future reference.

Thank you for choosing a Focus fireplace.

Manufactured by:
atelier dominique imbert s.a.s.
34380-Violis le fort-France
www.focus-creation.com

tested to USA: UL737-2011
CANADA: ULC S627-23

**CAUTION: HOT WHILE IN OPERATION
DO NOT TOUCH. KEEP CHILDREN AND
CLOTHING AWAY. CONTACT MAY
CAUSE SKIN BURNS. SEE NAMEPLATE AND
INSTRUCTIONS. KEEP FURNISHINGS AND OTHER
COMBUSTIBLE MATERIALS A CONSIDERABLE
DISTANCE AWAY FROM THIS APPLIANCE.**

Report Number: 8504WFB285

LISTED SOLID FUEL FIREPLACE SERIAL NO.
STOVE/MODEL: HETEROFOCUS 1400

DATE OF MANUFACTURE:
01 02 03 04 05 06 07 08 09 10 11 12 2005 2006 2007 2008 2009

**CLEARANCE TO COMBUSTIBLE SURFACES
(rear heatshield is required)**

A: UNIT TO SIDE WALL: 24" (610 mm)
B: UNIT TO BACK WALL: 24" (610 mm)
C: CHIMNEY CONNECTOR TO SIDEWALL: 38" (965 mm)
D: CHIMNEY CONNECTOR TO BACKWALL: 24" (610 mm)

WARNING: do not obstruct the space beneath the heater.

CAUTION : AIR INTAKE MANDATORY!
This fireplace requires a ducted supply of combustion air from outdoors (min. 06"-150mm). Fresh air intake may ideally be located close to the fireplace, or anywhere in the same room. As a result of fireplace operation, this heater may starve of combustion, ventilation and dilution air other fuel-burning appliances.

Gas logs shall be certified for the application. When installed the chimney damper shall be permanently secured in an open position to effectively vent the appliance.

FLOOR THERMAL PROTECTION

Floor protection must be made of non-combustible and insulating material (value R=2,13 or greater) extending beneath heater and to front / sides / rear as indicated on the diagram.

In the USA: 8" (203mm) to either side of the fireplace opening and 16" (406mm) to the front of the fireplace opening.
* In Canada 8" (203mm) to the sides and back of the fireplace and 18" (457mm) to the front of the fireplace.

CEILING THERMAL PROTECTION

Ceiling protection must be made of non-combustible and insulating material (value R=2,13 or greater) extending 12" (305mm) on all sides of flue.

PREVENT HOUSE FIRES:
Install and use only in accordance with manufacturer's installation and operation instructions and local codes. In absence of any local codes, installation must meet minimum requirements of NFPA 221 in USA, in Canada CSA B365. Refer to manufacturer's instructions and local codes for precautions required for passing chimney system through a combustible wall or ceiling. Inspect and clean chimney system frequently in accordance with manufacturer's instructions. Do not connect this unit to a chimney serving another appliance. For use with solid wood fuel only except when gas logset is installed. Do not use grate or elevate fire. Build wood fire directly on hearth. **OPERATE ONLY WITH SCREEN IN PLACE.** Must use flue connector, and connection pieces provided by Focus for installation. Damper control to be operated with cold handle provided and to be stored in lower pedestal drawer. Refer to owners manual for installation instructions. Chimney must be factory built UL 103HT for USA and ULC S629 for Canada. Inspect and clean chimney frequently. Under certain conditions of use, creosote build-up may occur rapidly. Contact local building or fire officials about restrictions and installation inspection in your area. **DO NOT OVERFIRE - IF UNIT OR CHIMNEY CONNECTOR GLOWS, YOU ARE OVERFIRING.**

Exempt from EPA Certification under 40CFR60.531

SPECIFICATIONS

⚠ WARNING :

DO NOT INSTALL IN ANY FIREPLACE. DO NOT INSTALL OUTDOORS.

DO NOT CONNECT OR USE IN CONJUNCTION WITH AIR DISTRIBUTION DUCTS UNLESS THEY ARE SPECIFICALLY APPROVED FOR THIS INSTALLATION.

DO NOT INSTALL IN A TRANSPORTABLE BUILDING.

■ DETAILED PLAN

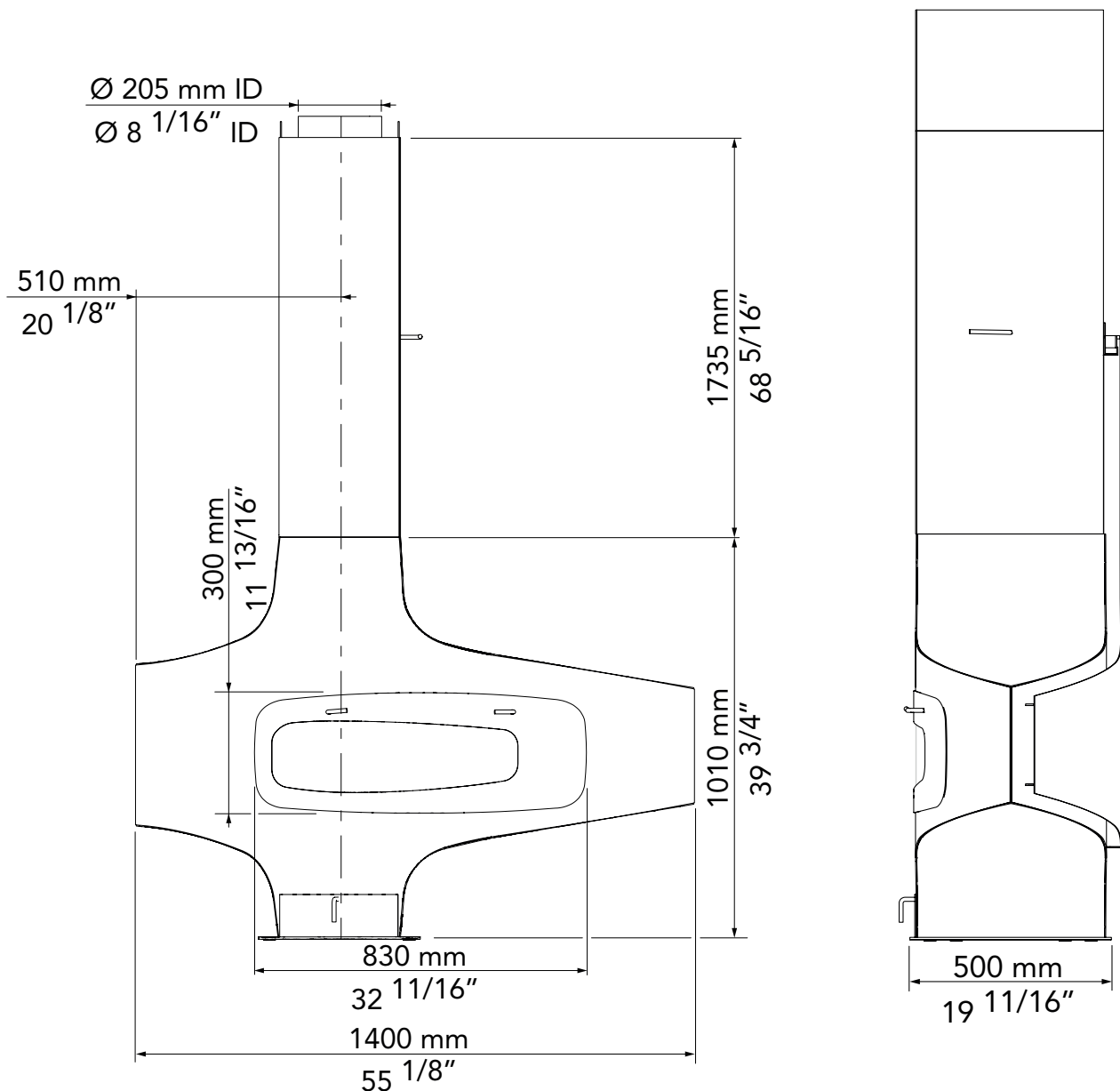

Hearth weight : 99 kg (218 lbs)

Steel flue weight : 30 kg/meter (66 lbs/foot)

SPECIFICATIONS

■ ROOF OUTLET REQUIREMENTS

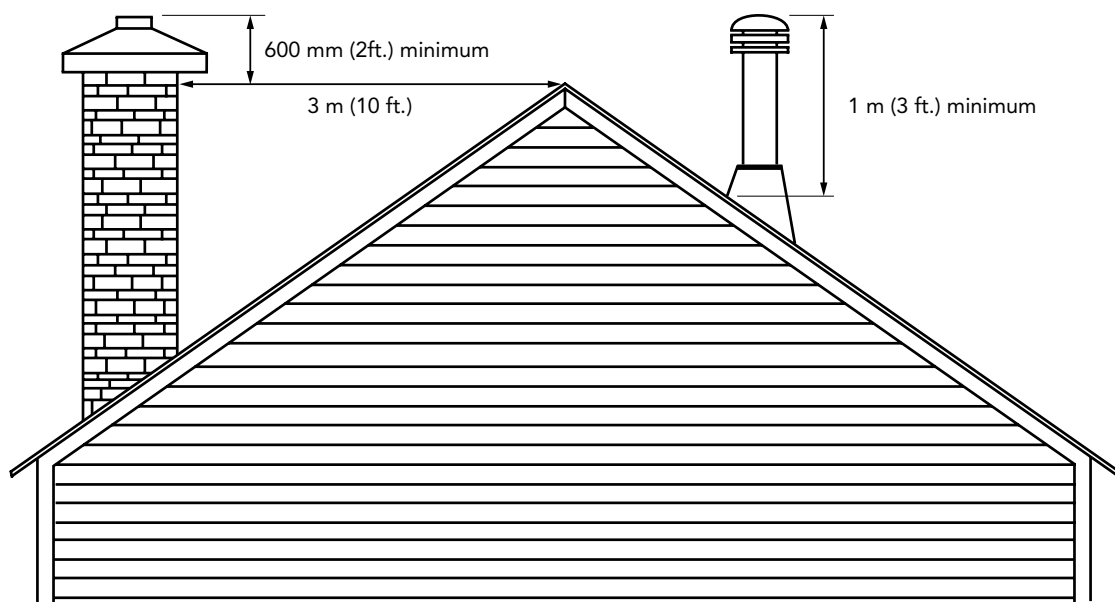

■ CHIMNEY REQUIREMENTS

WARNING :

DO NOT CONNECT THIS UNIT TO A CHIMNEY FLUE SERVING ANOTHER APPLIANCE.

The total length of the flue (interior + exterior) must be at least 4600 mm (15').

If the fireplace is installed less than 5 km (3 miles) from the ocean or with a 30° elbow or more, the total length must be at least 5500 mm (18').

The appliance must be connected to a flue that meets the specifications for HT-type chimneys, as described in the UL 103 / ULC S629 standard.

■ SUPPORTING STRUCTURE RULES

WARNING :

THE SUPPORT (FLOOR) MUST BE SIZED TO ACCOMMODATE BOTH THE STATIC AND DYNAMIC LOADS OF THE FIREPLACE. IT IS YOUR RESPONSIBILITY TO CONSULT AN ENGINEER OR ARCHITECT TO PERFORM THESE CALCULATIONS.

SPECIFICATIONS

■ CONNECTORS

All connectors, including the Focus steel flue and the finishing collar provided by the chimney manufacturer with a single-wall connection, are categorized as non-insulated chimney components.

To avoid thermal traps, it is essential that the chimney connector does not pass through an attic, roof space, closet, or any concealed area that could act as a heat trap, including floors or ceilings.

In cases where passing through an attic, roof framing, floor, or ceiling is unavoidable, it must be done using an insulated chimney.

Furthermore, strict adherence to the "safety distances from combustible materials" outlined on page 8 is essential.



WARNING :

PASSING THROUGH A WALL OR COMBUSTIBLE CONSTRUCTION IS NOT SUITABLE FOR THIS FIREPLACE.

■ FRESH AIR INLET DEVICE

For optimal performance, Focus recommends installing a fresh air intake in the room, ideally positioned beneath the fireplace. We suggest using the **Deflect-O A0684 semi-rigid aluminum duct**. The minimum size for the fresh air inlet is:

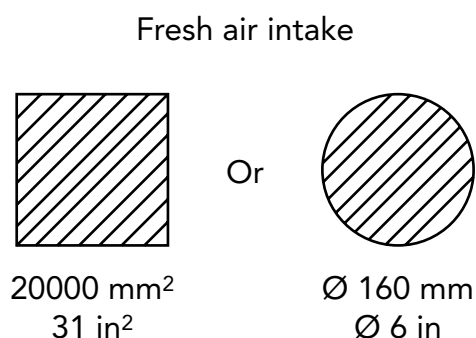

WARNING :

THIS FRESH AIR INLET DEVICE IS MANDATORY WHEN USING MECHANICAL VENTILATION SYSTEMS SUCH AS KITCHEN HOODS, PERMANENT AIR EXTRACTORS, OR ANY OTHER AIR CONDITIONING SYSTEM THAT CREATES A VACUUM IN THE HOME.

SPECIFICATIONS

■ FLOOR AND CEILING CLEARANCE REQUIREMENTS

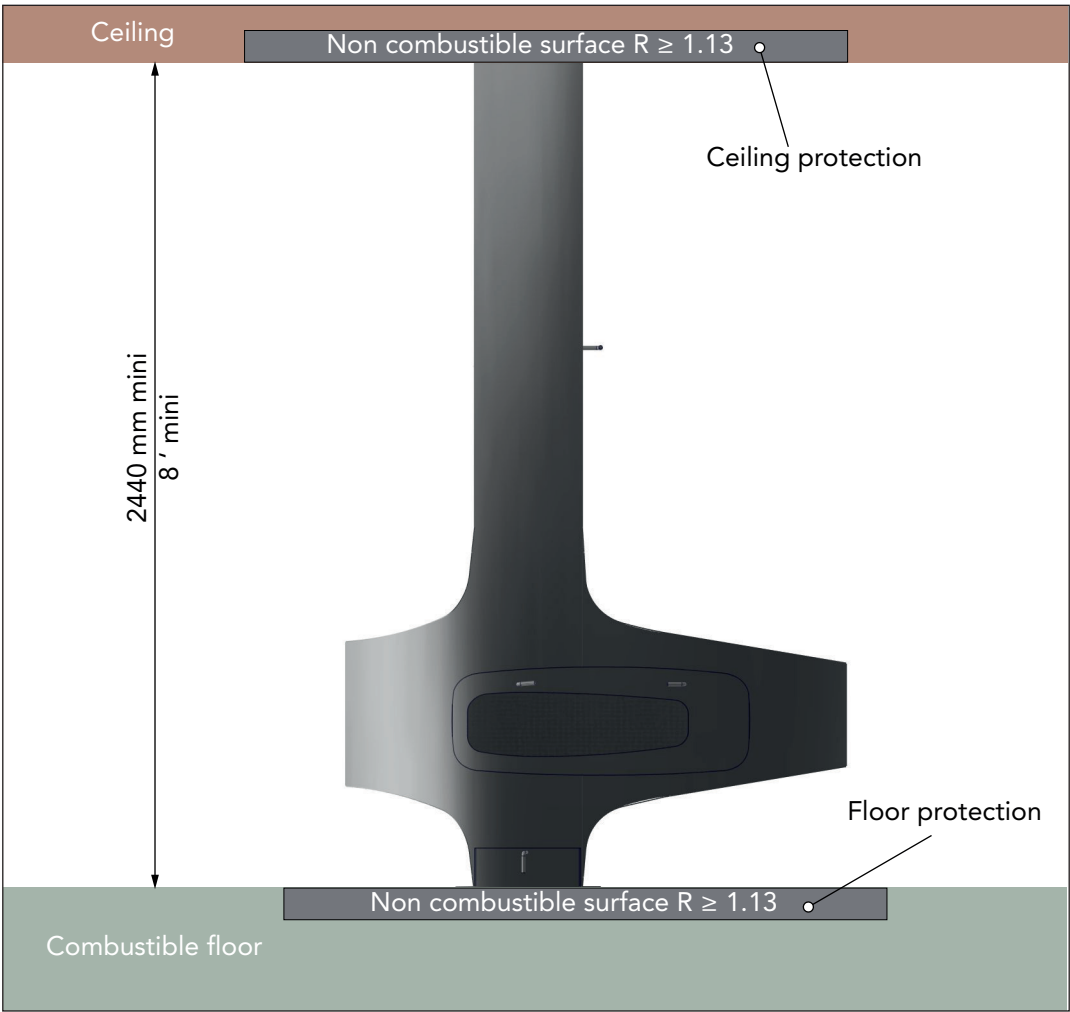

Floor protection :

Ceiling protection :

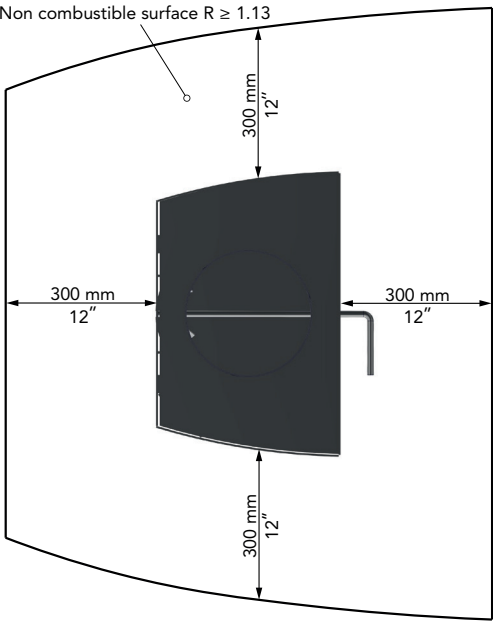
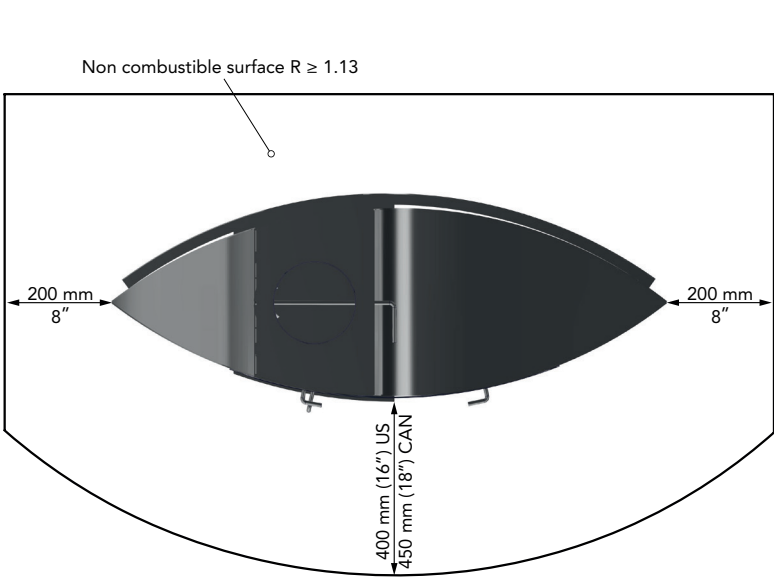

SPECIFICATIONS

■ WALL CLEARANCE REQUIREMENTS

Combustible wall clearance :

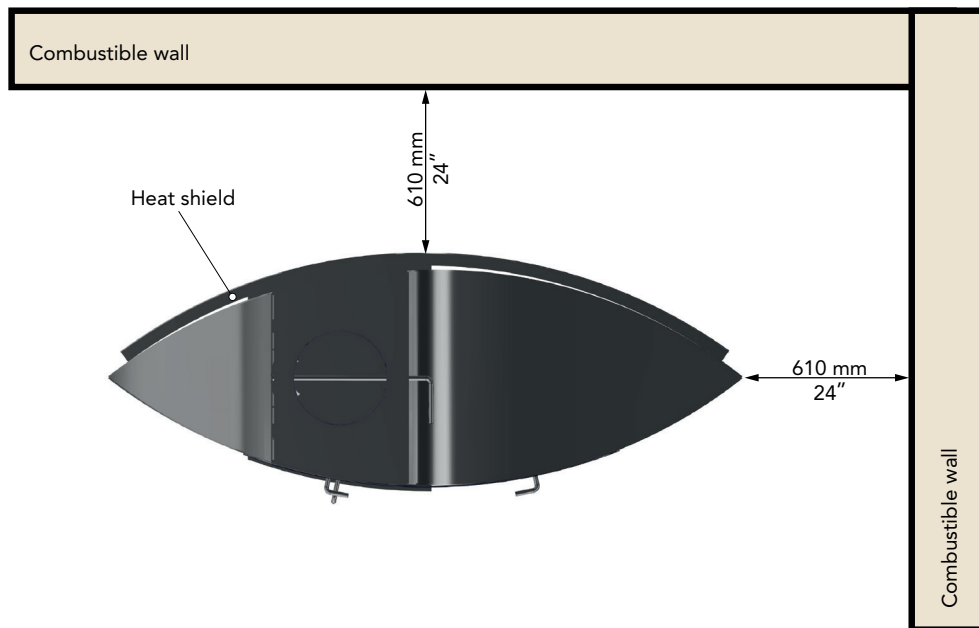

⚠ WARNING :

FIRE CLEARANCES MAY ONLY BE REDUCED WITH THE APPROVAL OF THE RELEVANT AUTHORITIES. DO NOT PLACE ANY COMBUSTIBLE MATERIAL IN FRONT OF THE FIREPLACE WITHIN 900 MM (36").

NOTE :

When the fireplace is placed near a non-combustible wall, maintain a minimum clearance of 100 mm (4") for adequate ventilation. To prevent premature aging of painted walls, only use mineral or acrylic paints.

To prevent premature aging of your painted walls, use only mineral or acrylic paints. For other types of paint, the fire clearance distances mentioned above apply.

Fire clearance for a PVC window: refer to the window's technical specifications.

SPECIFICATIONS

■ MATERIALS, PARTS, AND TOOLS INCLUDED FOR INSTALLATION

Supplied with Delivery :

- The fireplace.
- Steel flue.
- Insulating layer.
- Hearth base.
- Fire protection.
- The drawer.
- The removable cover
- The spark guard.
- Focus kit (thermal protective glove, assembly gloves, Zebraline, the cold handle and this manual)

Optional :

- Male extension on the ceiling.
- Steel flue extension.

Minimum Tools Required for Installation :

- Drill.
- Allen keys (M4).
- Screwdriver set.
- Open-end wrench (M12).
- Scaffolding (depending on ceiling height).
- A minimum of two people is required.

INSTALLATION

■ FIREPLACE INSTALLATION

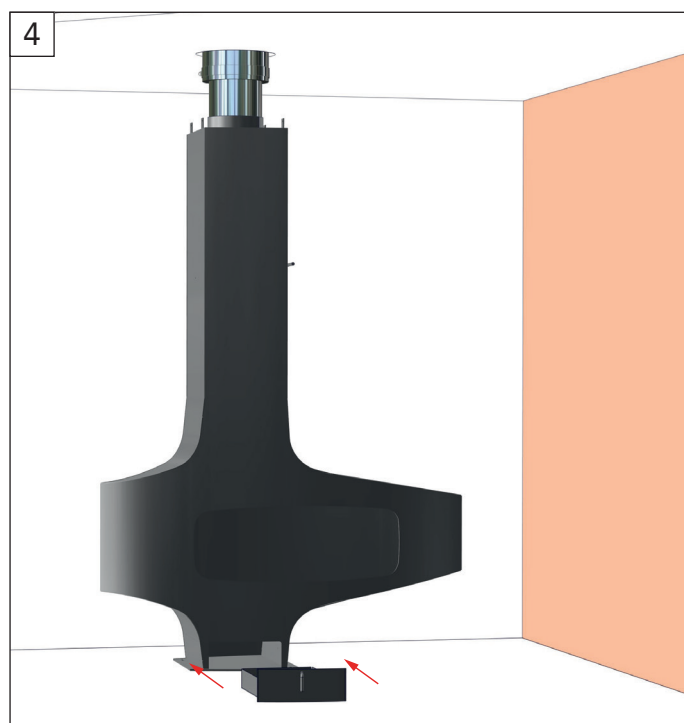
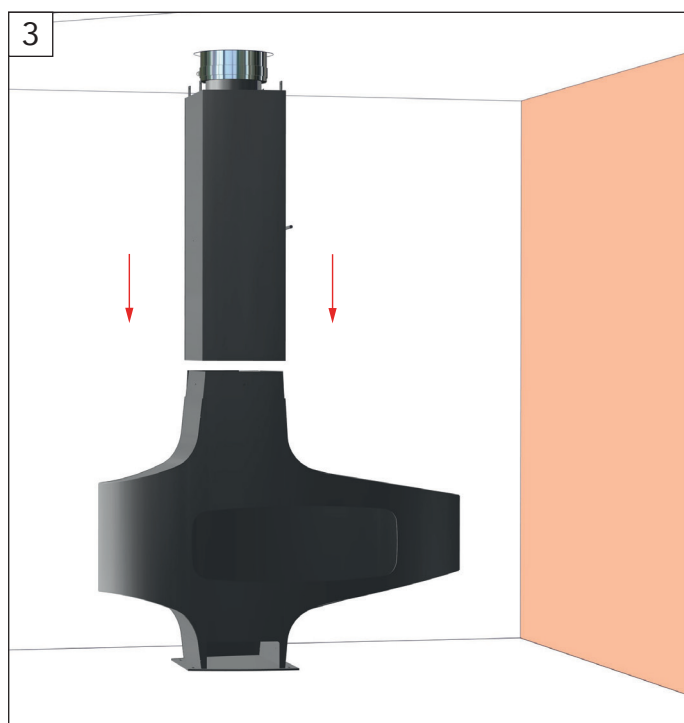
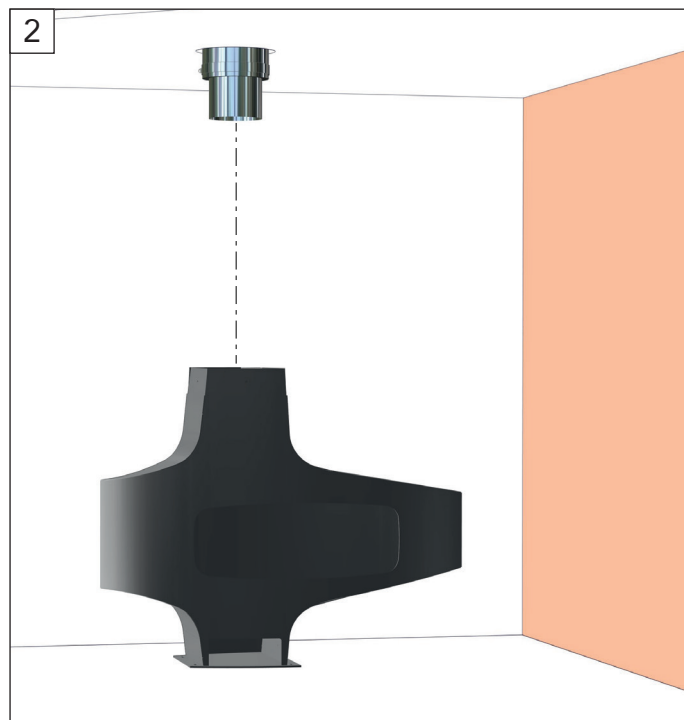
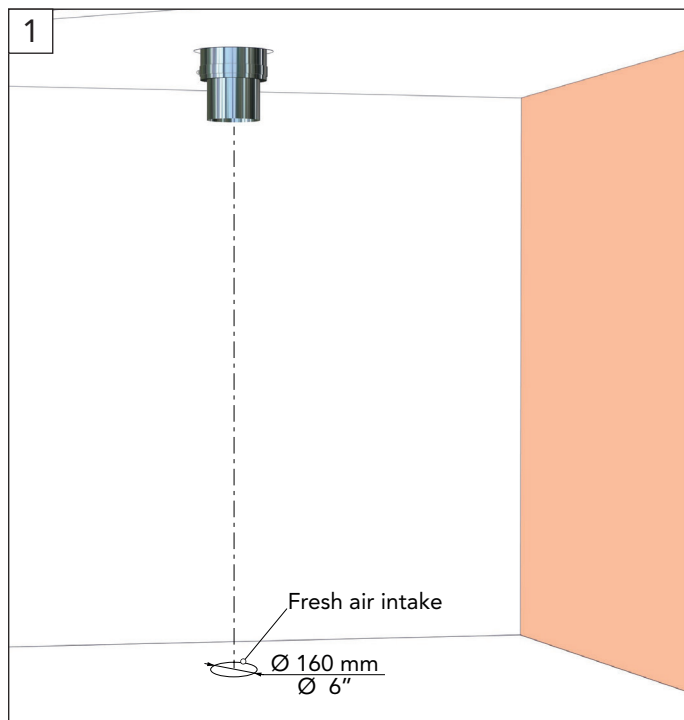

INSTALLATION

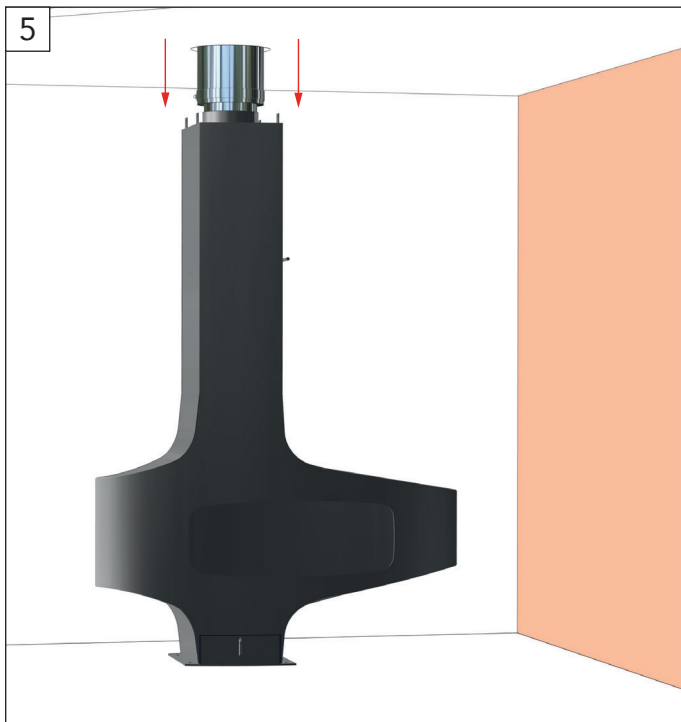

Lower the flue with the conical reducer.

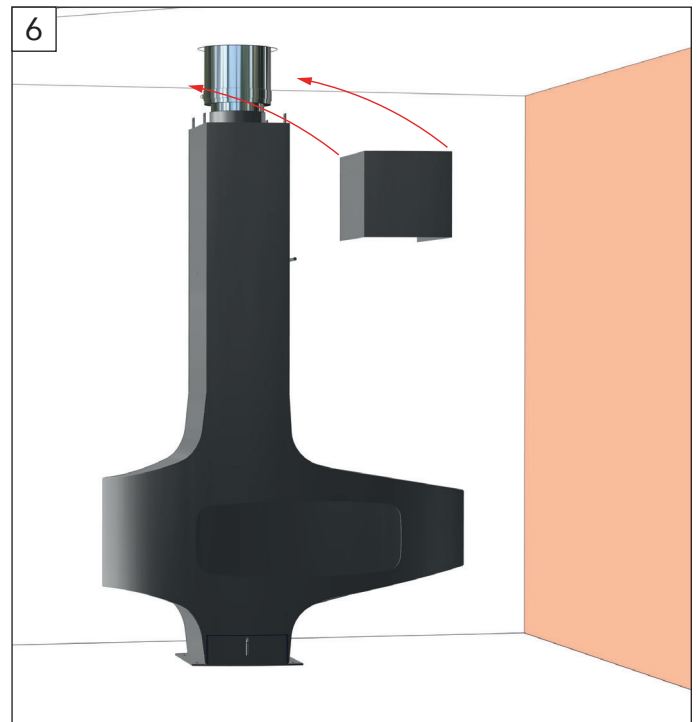

Tighten the removable cover using the four provided screws. A 12 mm (1/2") gap must be maintained between the ceiling and the cover.

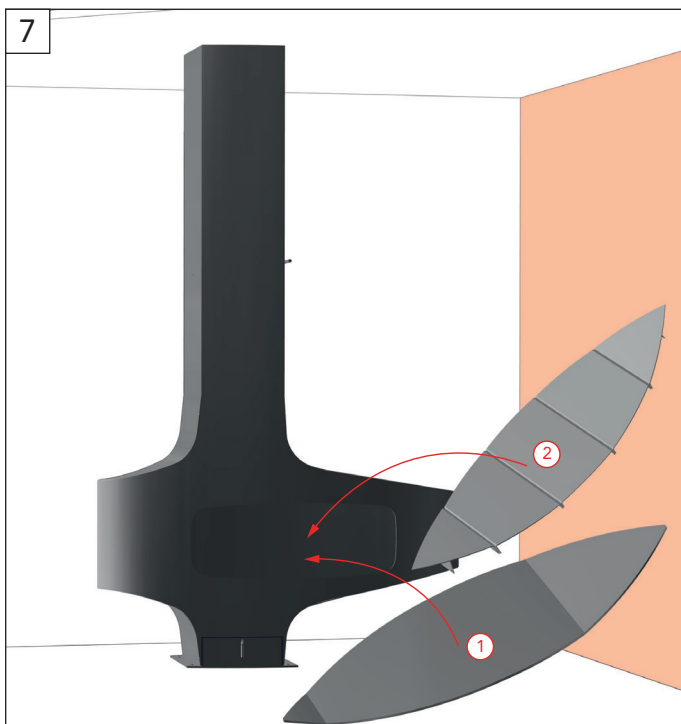

Place the hearth base in the fireplace.

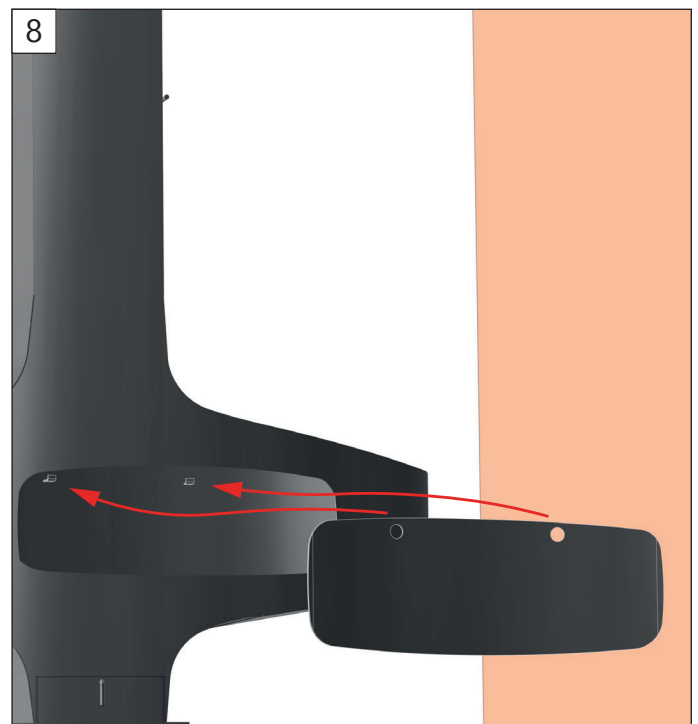

USE

WARNING :

DURING OPERATION, THE FIREPLACE EMITS HEAT. SURFACES CAN BECOME VERY HOT. KEEP CHILDREN, VULNERABLE INDIVIDUALS, CURTAINS, PETS, AND OTHER ITEMS AT A SAFE DISTANCE. ANY CONTACT MAY RESULT IN SEVERE BURNS.

■ **HANDLING FLAMMABLE PRODUCTS**

WARNING :

DO NOT USE CHEMICALS OR LIQUIDS TO LIGHT YOUR FIRE.

Do not use fuels such as lamp oil, various types of gasoline, kerosene, lighter fluid, or any other liquids to light or rekindle the fire. Ensure that these liquids are kept away from the fireplace.

■ **HEARTH BASE**

The hearth base is located in the combustion chamber. An insulating layer is placed under the “U” shaped plates on which the logs will be placed. These “U” shaped plates must be removed for cleaning. Before proceeding with cleaning, make sure that the fireplace is completely extinguished and that the embers are cold. The fire should only be made on this insulated hearth base.

■ **ASHES**

Ashes must be placed in a metal container with a tight-fitting lid. The closed container should be placed on a non-combustible surface, away from any flammable materials, until disposal. If the ashes are to be buried or dispersed, they must remain in the closed container until they are completely cooled.

■ **FUEL**

WARNING :

DO NOT BURN TRASH OR FLAMMABLE LIQUIDS SUCH AS GASOLINE, NAPHTHA, OR MOTOR OIL. DO NOT STORE FIREWOOD IN THE FIRE CLEARANCE ZONE AROUND THE FIREPLACE.

THIS FIREPLACE IS NOT DESIGNED TO BE USED WITH A DOOR. TO REDUCE THE RISK OF FIRE-RELATED INJURY, DO NOT INSTALL A DOOR ON THIS APPLIANCE.

Burn only natural, dry, log wood. The wood's moisture content should not exceed 20%. We recommend using dry wood that has been stored for 2 years. Use a covered shelter to store your wood.

USE

■ SPARK GUARD



WARNING :

GLOVES MUST BE WORN WHEN HANDLING THE SPARK GUARD.

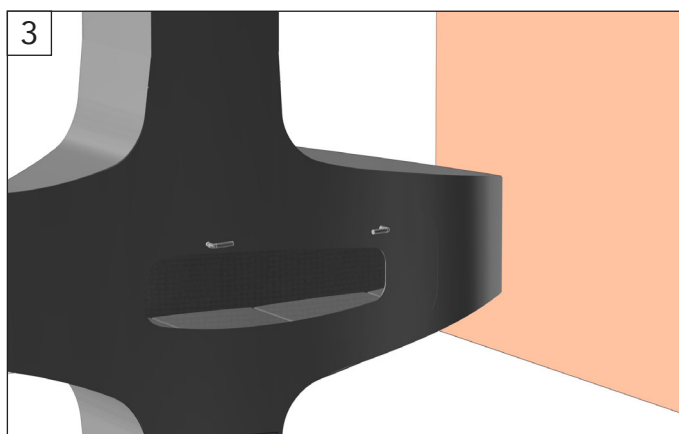
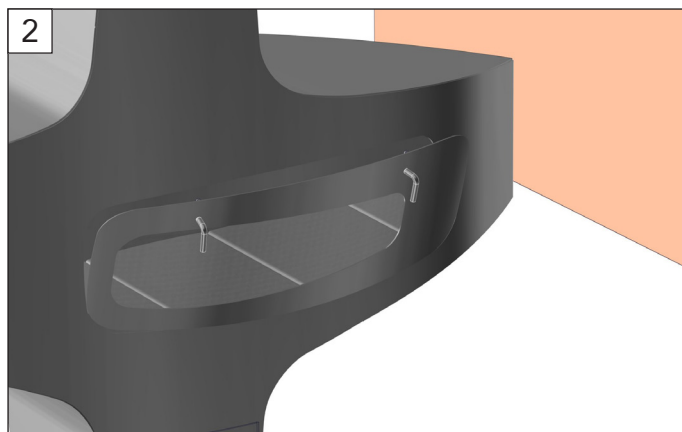
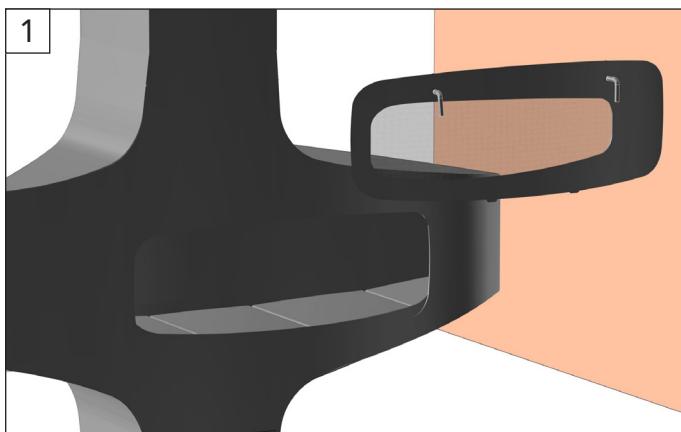

■ BEFORE YOUR FIRST FIRE

- Clean any dust accumulated during transport or installation using a damp sponge and/or a dry cloth.
- The finish of your Heterofocus is in waxed steel. A tube of "Zebraline" (metal wax) is provided with your fireplace for its maintenance.
- It is highly recommended to apply a layer of wax immediately after installation. Apply a layer of wax at least twice a year on your fireplace.
- This layer of wax is the only protection against oxidation of the fireplace, which would be irreversible.
- Make a first fire of low intensity.
- Do not burn the packaging of your fireplace or pallets in your Heterofocus.

■ LIGHTING AND MAINTAINING YOUR FIRE



WARNING :

DO NOT LIGHT A FIRE WITHOUT THE HEARTH BASE, AS THIS COULD CAUSE OVERHEATING OR A FIRE. DAMAGES CAUSED BY FAILURE TO COMPLY WITH THIS WARNING ARE NOT COVERED BY THE FOCUS WARRANTY.

DO NOT OVERLOAD YOUR FOCUS FIREPLACE TO PREVENT OVERHEATING.

DO NOT USE A GRATE, ANDIRON, OR ANY OTHER METHOD TO SUPPORT THE FIRE.

To light the fire, we recommend using a small amount of fire starter along with sufficient kindling (small logs, branches, etc.) to create an initial light fire.

Ensure the damper is fully open. Once the light fire is burning steadily, add larger logs (between 3 and 7 depending on their size), ensuring not to smother the fire.

Leave some gaps between the logs to allow airflow. Adjust the position of the damper to avoid smoke back-flow.

To maintain or sustain your fire, add logs as necessary (refer to the note below).

NOTE : 3 kg of wood split into 10 small logs will burn more intensely (and faster) than 3 kg of wood split into 3 larger logs. However, both will ultimately produce the same amount of heat. The size of the logs you add determines the intensity and duration of the fire.

■ PROTECTIVE GLOVES

The use of the Focus protective gloves provided with our models is required when handling the damper, the spark guard, and other components.

■ OPERATION AND USE OF THE DAMPER

The use of the cold hand tool or protective gloves is mandatory when handling the damper to avoid burns.

The Heterofocus damper has 4 positions :

- When the handle is vertical, the shutter is 0%.
- When the handle is horizontal, the shutter is 75%.
- The two intermediate positions allow adjustments between 0% and 75%.

To change the position of the damper, first pull the handle toward you, then turn it, and push it back to lock it into one of the predefined positions.

WARNING :

NEVER ADJUST THE DAMPER TO AN INTERMEDIATE POSITION. THE DAMPER POSITION MUST BE ADAPTED TO THE INTENSITY OF THE FIRE. DURING IGNITION, IT SHOULD BE FULLY OPEN. IT SHOULD THEN BE ADJUSTED TO REDUCE THE SMOKE FLOW, ENSURING OPTIMAL THERMAL EFFICIENCY.

IF THE FIREPLACE BACK DRAFTS, THIS INDICATES THAT THE DAMPER IS OBSTRUCTING THE CHIMNEY TOO MUCH: REOPEN THE DAMPER AT THE FIRST SIGNS OF BACK DRAFTING.

MAINTENANCE

■ ASH REMOVAL



WARNING :

ENSURE THE FIRE IS EXTINGUISHED AND THE FIREPLACE SURFACES ARE COMPLETELY COOL BEFORE PROCEEDING WITH ASH REMOVAL.

To remove the ashes, we recommend using a shovel and a brush (the drawer can be used as a receptacle to transport the ashes). After cleaning, ensure that the insulated hearth base is correctly positioned.

■ CREOSOTE FORMATION

When wood burns slowly, it produces tar and other organic vapors that combine with expelled moisture to form creosote. These creosote vapors condense in the relatively cool chimney of a slow-burning fire. As a result, creosote residues accumulate on the chimney walls. If ignited, this creosote produces an extremely hot fire.

Therefore, the chimney and chimney connector must be **inspected at least once every two months during the heating season** to determine if creosote has accumulated. If a significant layer of creosote (3 mm or more) has built up, it must be removed to reduce the risk of a chimney fire.

■ CHIMNEY SWEEPING

The Focus steel flue, stainless steel chimney, and single-wall connector must always be cleaned using a nylon brush. Never use a metal brush! Damage resulting from non-compliance with this instruction is not covered by the Focus warranty.



WARNING :

CHEMICAL CHIMNEY SWEEPING IS PROHIBITED. ONLY MECHANICAL SWEEPING IS ALLOWED.

MAINTENANCE

■ SURFACE CLEANING

The exterior surfaces can be cleaned with a soft, dry cloth or a damp sponge (ensuring the fireplace is cool).



WARNING :

DO NOT SCRAPE THE FIREPLACE. USE THE PROVIDED ZEBRALINE TO PROTECT YOUR FIREPLACE.

■ SPARE PARTS

Note : In the event of a part replacement, use only parts recommended by Focus. Failure to comply with this note will automatically void the warranty.

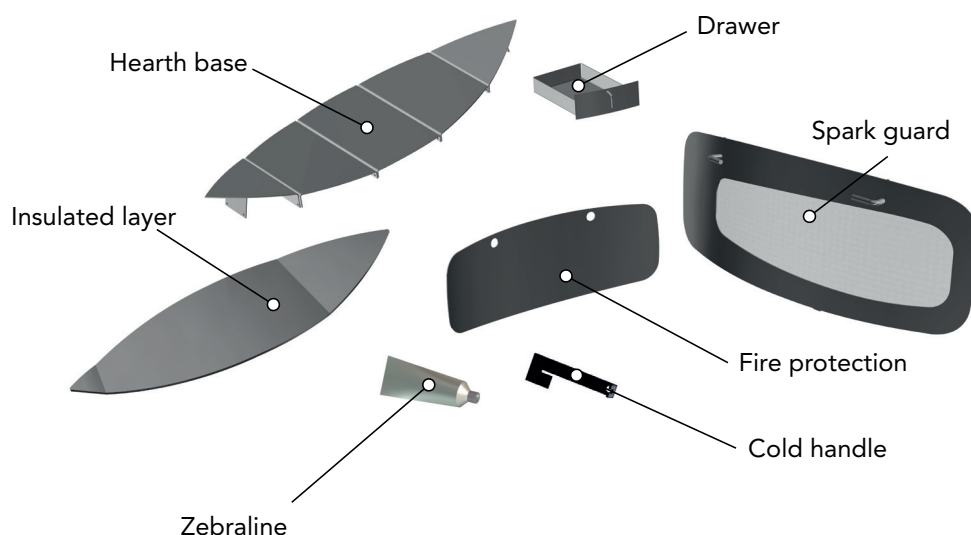

To order these parts, contact :



30 Log Bridge Road
Building 300 – Suite 303
Middleton, MA 01949
T: 781-324-8383
www.europeanhome.com

WARRANTY

All our Focus models are guaranteed against any defects in design, construction, and manufacturing, and are guaranteed to function properly for 5 years from the date of purchase. The warranty for our products is only applicable when our fireplaces have been installed in compliance with all local building regulations and with strict attention to the technical details described in our design plans, installation manuals, maintenance manuals, and user manuals. Our warranties exclude accidental damage, such as those occurring during transport without written notification upon receipt (reservations), damage caused during installation, and damage resulting from improper use. Exclusion of the warranty applies to the coating for appliances located less than 10 km from a saline environment.



CREATE BEYOND CONVENTION

Focus – Atelier Dominique Imbert
3 impasse Claque Patin, Viols le fort, France
www.focus-creation.com
info@focus-creation.com